

GEZE INSTALLATION OPTIONS

RECOMMENDED SETTINGS FOR GEZE DOOR CLOSERS

► Remove slide plate

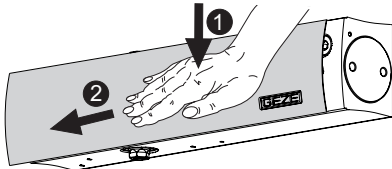

► Clip slide plate open

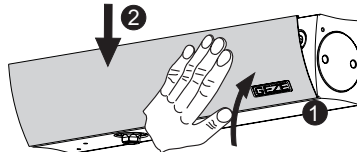

► Set

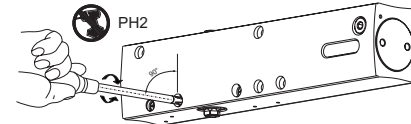

GEZE TS 5000

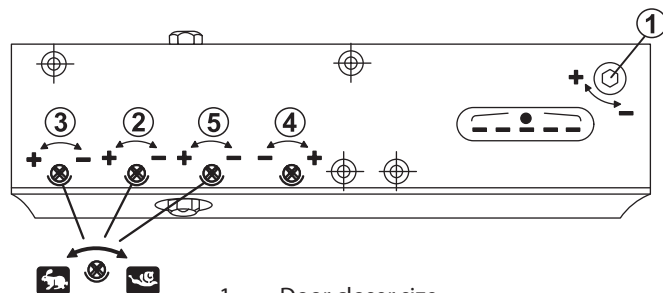

- 1 Door closer size
- 2 Closing speed
- 3 Latching action
- 4 Back check
- 5 Delayed closing action (only with TS 5000 S)

Display door closer size	Leaf width [mm]
2	up to 850
3	850 - 950
4	950 - 1100
5	1100 - 1250
6	1250 - 1400

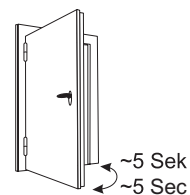

Light-running door must be closed completely by the closer!

GEZE TS 4000

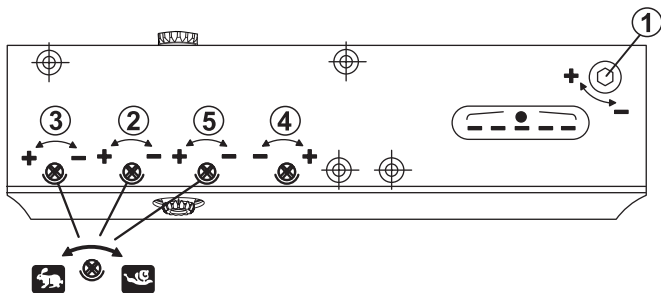

- 1 Door closer size
- 2 Closing speed
- 3 Latching action (only with TS 4000 S)
- 4 Back check
- 5 Delayed closing action (only with TS 4000 S)

Display door closer size	Leaf width [mm]
1	up to 750
2	750 - 850
3	850 - 950
4	950 - 1100
5	1100 - 1250
6	1250 - 1400

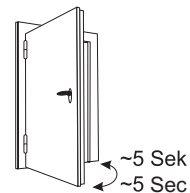

Light-running door must be closed completely by the closer!

Setting latching action	with latching action	without latching action
-------------------------	----------------------	-------------------------

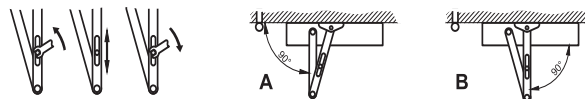

GEZE INSTALLATION OPTIONS

GEZE TS 3000 V

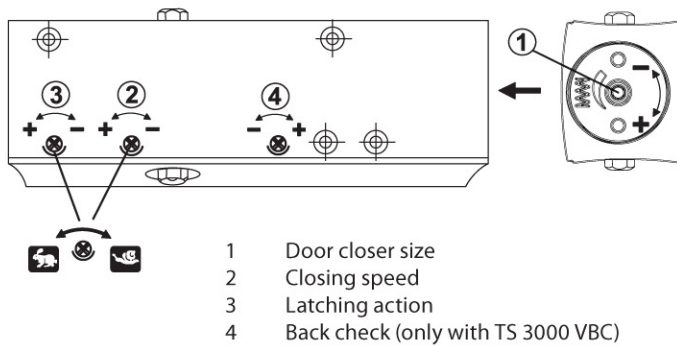

Setting door closer size	Leaf width [mm]
Buffer -	up to 750
2.5 revolutions	750 - 850
5 revolutions	850 - 950
Buffer +	950 - 1100

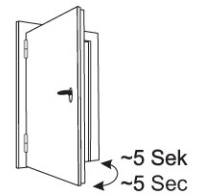

Light-running door must be closed completely by the closer!

GEZE TS 2000 V

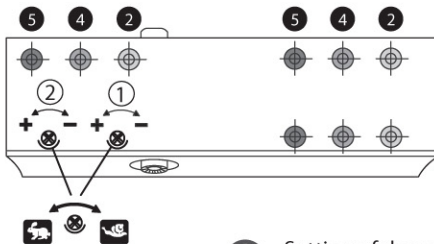

! Setting of door closer size through offset installation

Setting door closer size	Leaf width [mm]
2 Size 2	750 - 850
4 Size 4	850 - 1100
5 Size 5	1100 - 1250

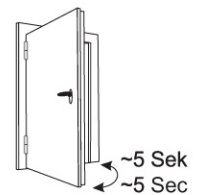

Light-running door must be closed completely by the closer!

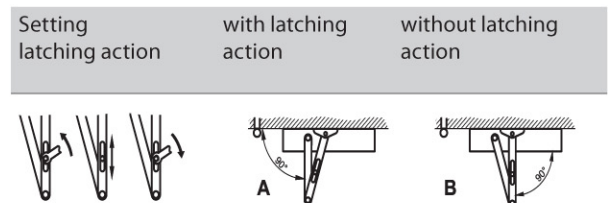

GEZE TS 2000 NV

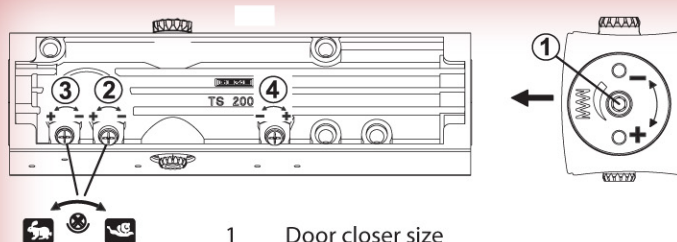

Setting door closer size	Leaf width [mm]
Buffer -	up to 850
4 revolutions	850 - 950
Buffer +	up to 1100

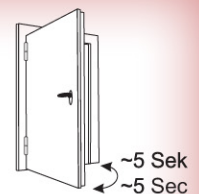

Light-running door must be closed completely by the closer!

GEZE TS 1500

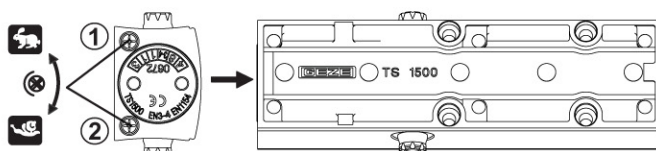

! Setting of door closer size by turning the top of the link arm

Setting door closer size	Leaf width [mm]
Diagram A	850 - 950
Diagram B	950 - 1100

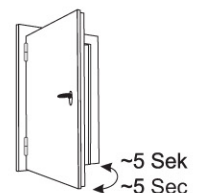

Light-running door must be closed completely by the closer!

GEZE INSTALLATION OPTIONS

General product information about GEZE overhead door closers

Door closer sizes

acc. to EN 1154	Door leaf width in mm
Size 1	up to 750
Size 2	from 750 to 850
Size 3	from 850 to 950
Size 4	from 950 to 1100
Size 5	from 1100 to 1250
Size 6	from 1250 to 1400
Size 7	from 1400 to 1600

Notes for door closers with guide rail for installation on the opposite hinge side

Note: The max. door opening angle must be limited by a door stopper or by use of the GEZE T-Stop guide rail!

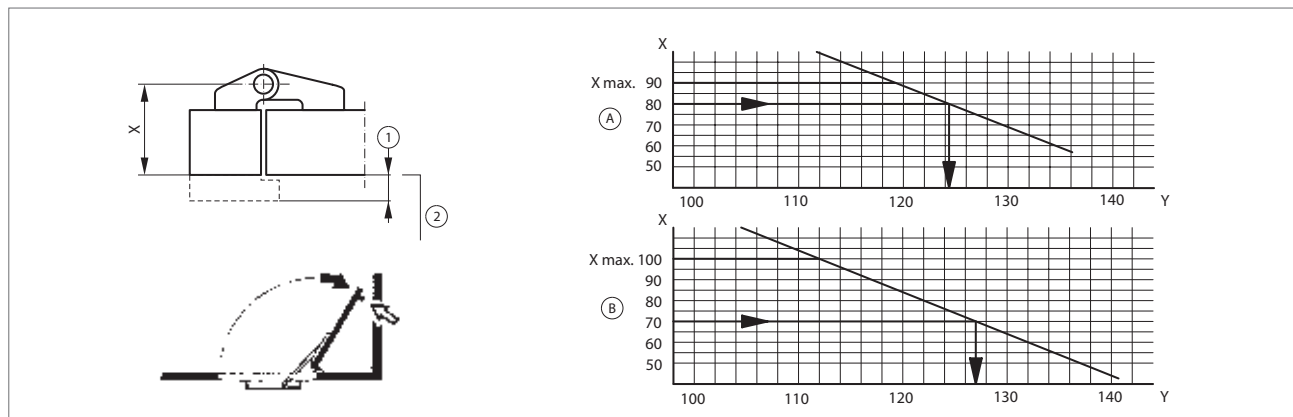

1 = Overlap max. 15 mm

2 = Flush-mounted door

X = Distance pivot point to contact area of guide rail

X dimension max. = 100 mm (double-leaf) / 90 mm (single-leaf)

A = Single-leaf systems

B = Double-leaf systems

Y = Door opening angle

Special mounting dimensions are used when the X dimension is wider – on request.

Notes for door closers with link arm for installation on the opposite hinge side

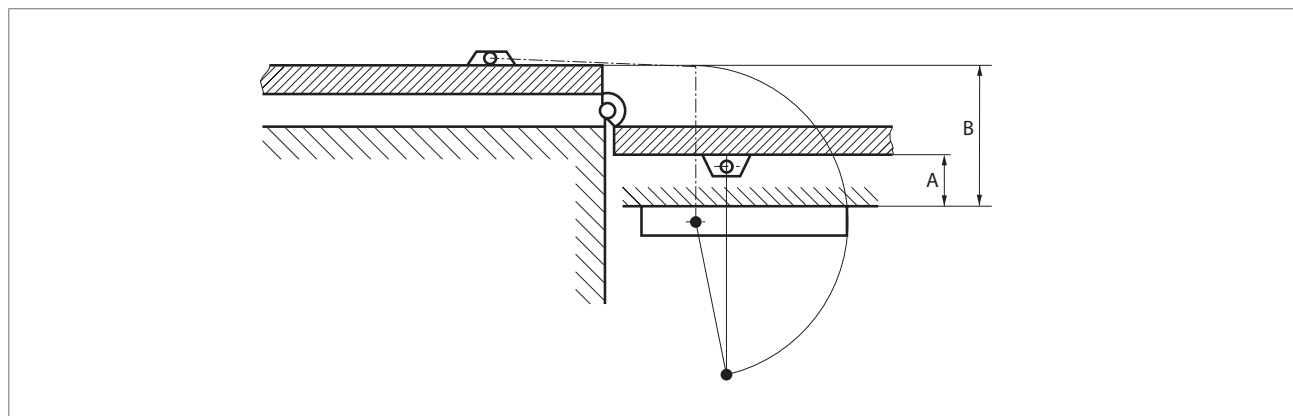

A = Reveal depth

B = Reveal depth + 2 door size + 2 pivot point distance

Door opening up to 180° is only possible if the following dimensions are not exceeded:

A = 70 mm and B = 200 mm

GEZE INSTALLATION OPTIONS

GEZE TS 2000 NV / NV BC

Door leaf installation hinge side

TS 2000 NV Door leaf installation/hinge side

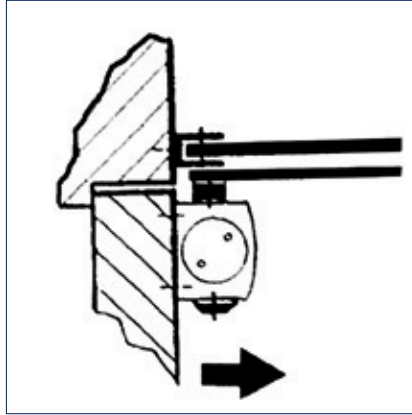
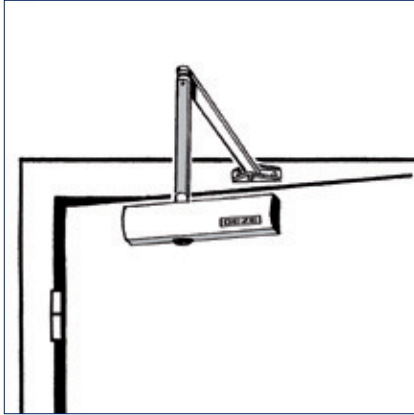

Area of application

- Closing force 2-4 according to EN 1154, leaf width up to 1100 mm
- Can be used for right and left hung doors without conversion
- For fire protection doors (door closer with mounting plate)

Order information

Description	Version	ID.No.
GEZE TS 2000 NV BC Closer Size EN 2-4 with back check (without link arms)	silver	124944
GEZE TS 2000 NV Closer Size EN 2-4 (without link arms)	silver	128885
Link arms TS 4000/2000 Standard	silver	102421
Link arms TS 4000/2000 with mechanical hold-open device which can be switched on and off	silver	102445
Link arms TS 4000/2000 with mechanical hold-open device	silver	102454
Accessories		
Mounting plate door closer for TS 2000 NV & NV BC with hole pattern according to DIN EN 1154 Supplement 1		126234

Note: See our system catalogues for further accessories and colour variants.

GEZE TS 2000 NV / NV BC

Door leaf installation opposite hinge side with PA bracket for parallel arm installation

TS 2000 NV Door leaf installation/opposite hinge side parallel arm installation

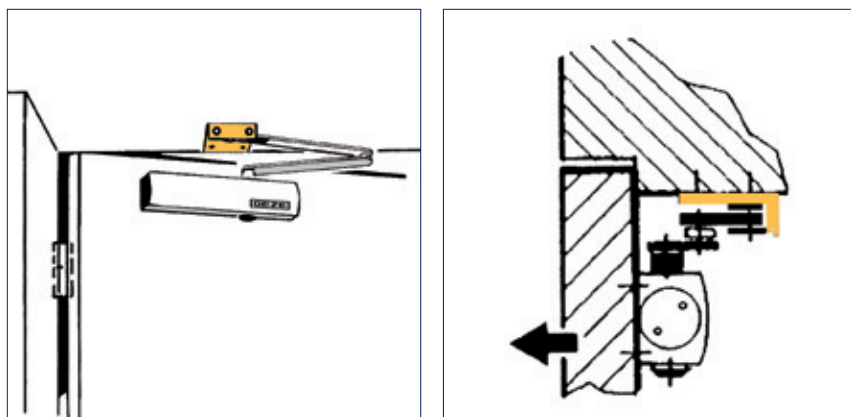

Area of application

- Closing force 2-4 according to EN 1154, leaf width up to 1100 mm
- Can be used for right and left hung doors without conversion
- Note for rescue routes, restriction of passage height by approx. 30 mm

Order information

Description	Version	ID.No.
GEZE TS 2000 NV BC Closer Size EN 2-4 with back check (without link arms)	silver	124944
GEZE TS 2000 NV Closer Size EN 2-4 (without link arms)	silver	128885
Link arms TS 4000/2000 Standard	silver	102421
Link arms TS 4000/2000 with mechanical hold-open device which can be switched on and off	silver	102445
Link arms TS 4000/2000 with mechanical hold-open device	silver	102454
Accessories		
Mounting plate link arms for TS 4000/TS 2000, for parallel arm installation	silver	053318
Mounting plate door closer for TS 2000 NV & NV BC with hole pattern according to DIN EN 1154 Supplement 1		126234

Note: See our system catalogues for further accessories and colour variants.

GEZE INSTALLATION OPTIONS

GEZE TS 2000 NV / NV BC

Door leaf installation hinge side with mounting plate for segmental arch door

TS 2000 NV Door leaf installation/hinge side segmental arch

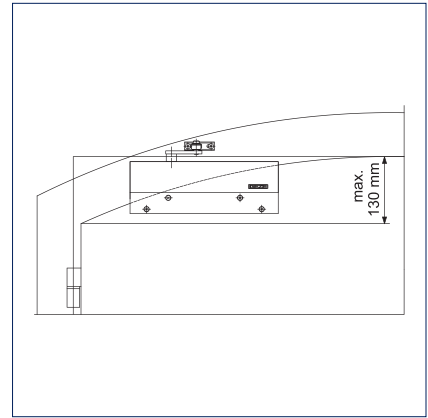
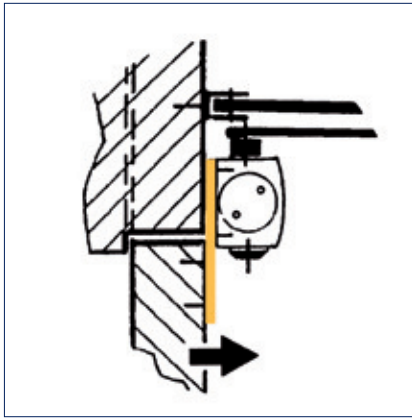
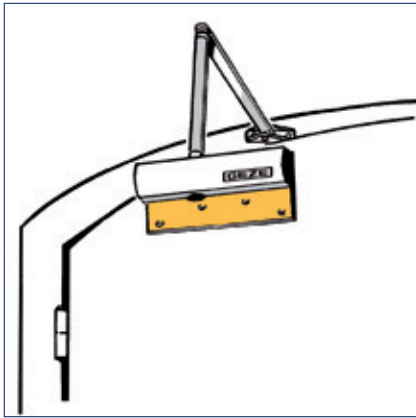

Area of application

- Closing force 2-4 according to EN 1154, leaf width up to 1100 mm
- Can be used for right and left hung doors without conversion
- Semi/segmental arch doors, max. arch height approx. 130 mm

Order information

Description	Version	ID.No.
GEZE TS 2000 NV BC Closer Size EN 2-4 with back check (without link arms)	silver	124944
GEZE TS 2000 NV Closer Size EN 2-4 (without link arms)	silver	128885
Link arms TS 4000/2000 Standard	silver	102421
Link arms TS 4000/2000 with mechanical hold-open device which can be switched on and off	silver	102445
Link arms TS 4000/2000 with mechanical hold-open device	silver	102454
Accessories		
Mounting plate segmental arch door for TS 2000 NV, arch height max. 130 mm	silver	127434

Note: See our system catalogues for further accessories and colour variants.

GEZE TS 2000 NV / NV BC

Door leaf installation hinge side with clamping shoe for all-glass door

TS 2000 NV Door leaf installation/hinge side clamping shoe glass

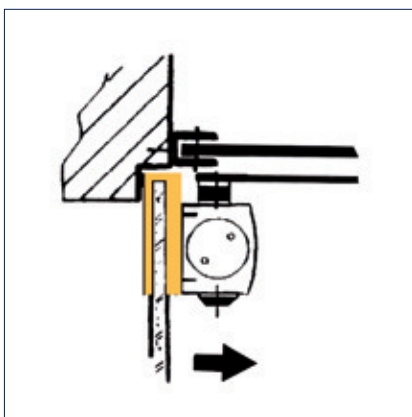

Area of application

- Closing force 2-4 according to EN 1154, leaf width up to 1100 mm
- Can be used for right and left hung doors without conversion
- Clamping shoe, glass thickness 8-10 mm
- Variant with mounting and counterplate also possible, glass thickness 10 / 12 mm

Order information

Description	Version	ID.No.
GEZE TS 2000 NV BC Closer Size EN 2-4 with back check (without link arms)	silver	124944
GEZE TS 2000 NV Closer Size EN 2-4 (without link arms)	silver	128885
Link arms TS 4000/2000 Standard	silver	102421
Link arms TS 4000/2000 with mechanical hold-open device which can be switched on and off	silver	102445
Link arms TS 4000/2000 with mechanical hold-open device	silver	102454
Accessories		
Glass clamping shoe door closer for TS 3000/TS 2000 NV	silver	014835
Mounting and counterplate for all-glass door for TS 3000/TS 2000 NV	silver	090259

Note: See our system catalogues for further accessories and colour variants.

GEZE INSTALLATION OPTIONS

GEZE TS 2000 NV / NV BC

Door leaf installation hinge side with mounting plate for link arms on slim frames

TS 2000 NV Door leaf installation/hinge side MP slim frame

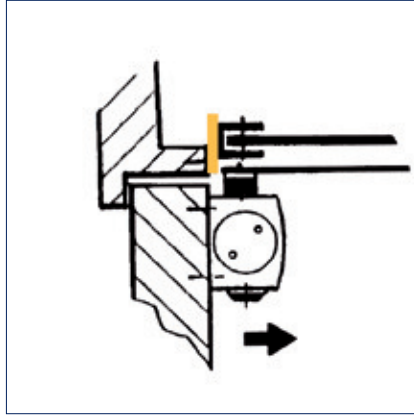
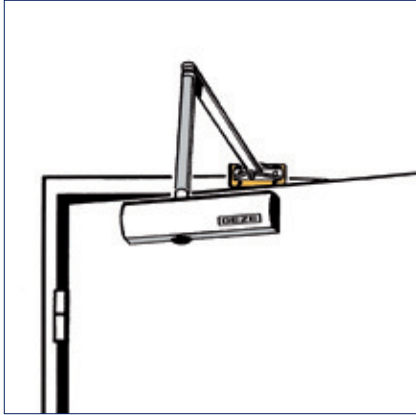

Area of application

- Closing force 2-4 according to EN 1154, leaf width up to 1100 mm
- Can be used for right and left hung doors without conversion
- For fire protection doors (door closer with mounting plate)

Order information

Description	Version	ID.No.
GEZE TS 2000 NV BC Closer Size EN 2-4 with back check (without link arms)	silver	124944
GEZE TS 2000 NV Closer Size EN 2-4 (without link arms)	silver	128885
Link arms TS 4000/2000 Standard	silver	102421
Link arms TS 4000/2000 with mechanical hold-open device which can be switched on and off	silver	102445
Link arms TS 4000/2000 with mechanical hold-open device	silver	102454
Accessories		
Mounting plate link arms for TS 4000/TS 2000, with slim frames	silver	057109
Mounting plate door closer for TS 2000 NV & NV BC with hole pattern according to DIN EN 1154 Supplement 1		126234

Note: See our system catalogues for further accessories and colour variants.

GEZE TS 2000 NV / NV BC

Transom installation opposite hinge side

TS 2000 NV Transom installation/opposite hinge side

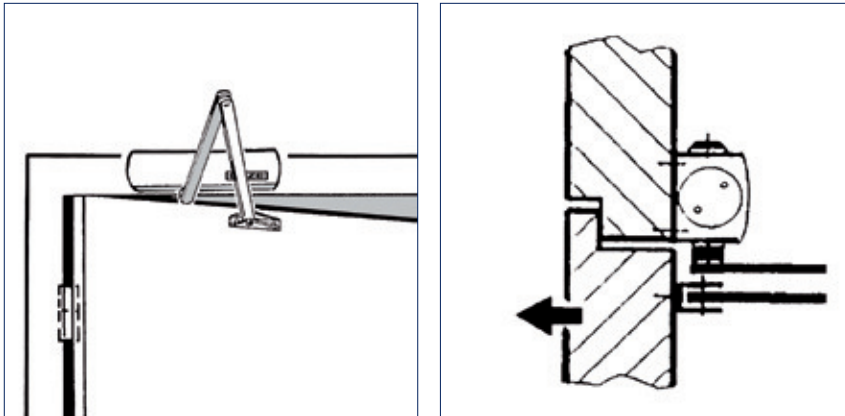

Area of application

- Closing force 2-4 according to EN 1154, leaf width up to 1100 mm
- Can be used for right and left hung doors without conversion
- For fire protection doors with respective suitability certificate

Order information

Description	Version	ID.No.
GEZE TS 2000 NV BC Closer Size EN 2-4 with back check (without link arms)	silver	124944
GEZE TS 2000 NV Closer Size EN 2-4 (without link arms)	silver	128885
Link arms TS 4000/2000 Standard	silver	102421
Link arms TS 4000/2000 with mechanical hold-open device which can be switched on and off	silver	102445
Link arms TS 4000/2000 with mechanical hold-open device	silver	102454
Accessories		
Mounting plate door closer for TS 2000 NV & NV BC with hole pattern according to DIN EN 1154 Supplement 1		126234

Note: See our system catalogues for further accessories and colour variants.

GEZE INSTALLATION OPTIONS

GEZE TS 2000 NV / NV BC

Transom installation opposite hinge side with lintel casing bracket

TS 2000 NV Transom installation/opposite hinge side lintel casing bracket

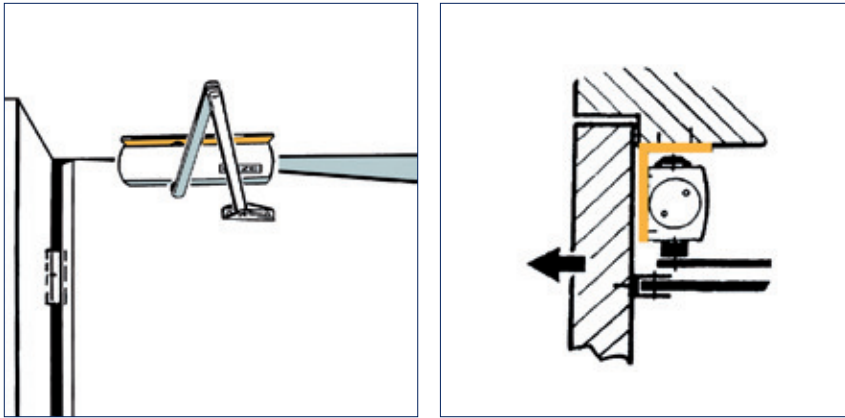

Area of application

- Closing force 2-4 according to EN 1154, leaf width up to 1100 mm
- Can be used for right and left hung doors without conversion
- Note for emergency exit routes, restriction of passage height by approx. 100 mm
- For fire protection doors with respective suitability certificate

Order information

Description	Version	ID.No.
GEZE TS 2000 NV BC Closer Size EN 2-4 with back check (without link arms)	silver	124944
GEZE TS 2000 NV Closer Size EN 2-4 (without link arms)	silver	128885
Link arms TS 4000/2000 Standard	silver	102421
Link arms TS 4000/2000 with mechanical hold-open device which can be switched on and off	silver	102445
Link arms TS 4000/2000 with mechanical hold-open device	silver	102454
Accessories		
Lintel casing bracket transom installation BG for TS 2000 NV / TS 3000 V	silver	127432

Note: See our system catalogues for further accessories and colour variants.