

GEZE INSTALLATION OPTIONS

RECOMMENDED SETTINGS FOR GEZE DOOR CLOSERS

► Remove slide plate

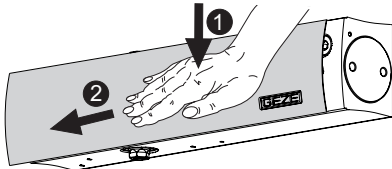

► Clip slide plate open

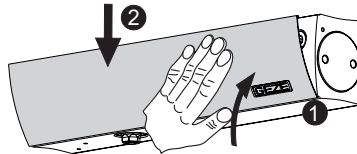

► Set

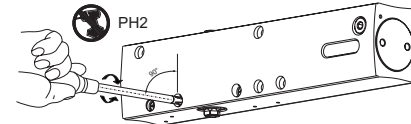

GEZE TS 5000

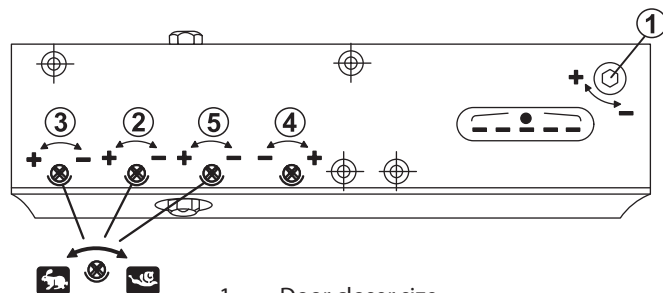

- 1 Door closer size
- 2 Closing speed
- 3 Latching action
- 4 Back check
- 5 Delayed closing action (only with TS 5000 S)

Display door closer size	Leaf width [mm]
2	up to 850
3	850 - 950
4	950 - 1100
5	1100 - 1250
6	1250 - 1400

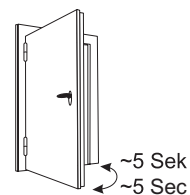

Light-running door must be closed completely by the closer!

GEZE TS 4000

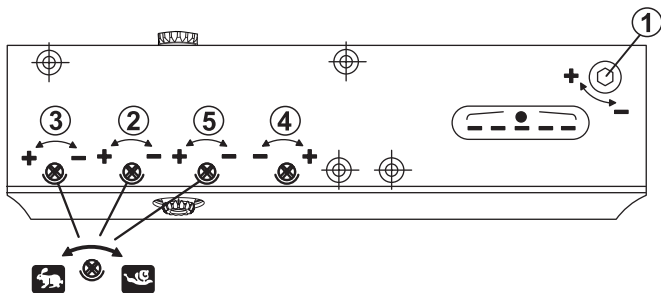

- 1 Door closer size
- 2 Closing speed
- 3 Latching action (only with TS 4000 S)
- 4 Back check
- 5 Delayed closing action (only with TS 4000 S)

Display door closer size	Leaf width [mm]
1	up to 750
2	750 - 850
3	850 - 950
4	950 - 1100
5	1100 - 1250
6	1250 - 1400

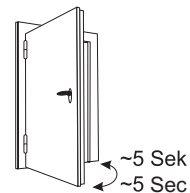

Light-running door must be closed completely by the closer!

Setting latching action	with latching action	without latching action
-------------------------	----------------------	-------------------------

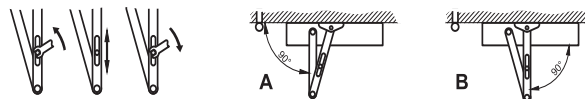

GEZE INSTALLATION OPTIONS

GEZE TS 3000 V

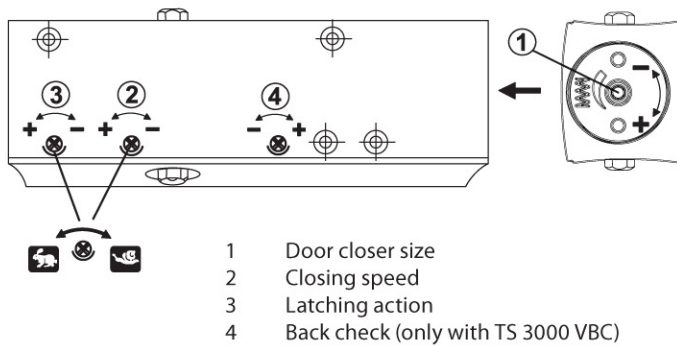

Setting door closer size	Leaf width [mm]
Buffer -	up to 750
2.5 revolutions	750 - 850
5 revolutions	850 - 950
Buffer +	950 - 1100

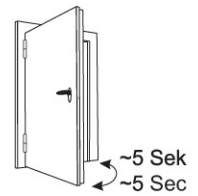

Light-running door must be closed completely by the closer!

GEZE TS 2000 V

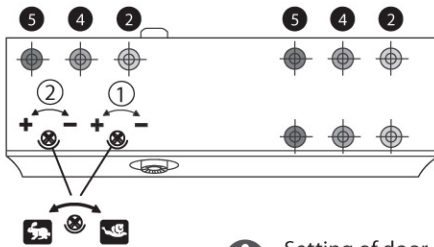

! Setting of door closer size through offset installation

Setting door closer size	Leaf width [mm]
2 Size 2	750 - 850
4 Size 4	850 - 1100
5 Size 5	1100 - 1250

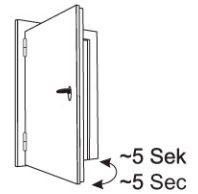

Light-running door must be closed completely by the closer!

Setting latching action	with latching action	without latching action

GEZE TS 2000 NV

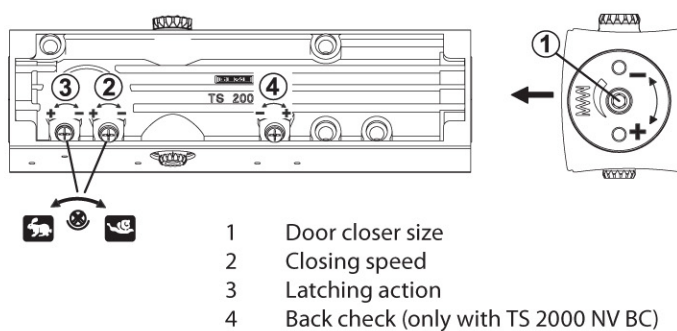

Setting door closer size	Leaf width [mm]
Buffer -	up to 850
4 revolutions	850 - 950
Buffer +	up to 1100

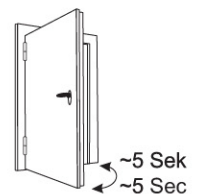

Light-running door must be closed completely by the closer!

GEZE TS 1500

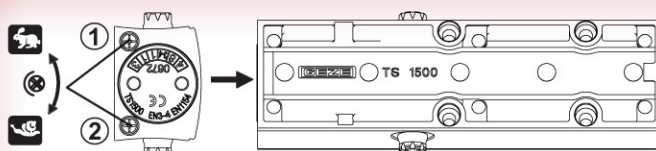

! Setting of door closer size by turning the top of the link arm

Setting door closer size	Leaf width [mm]
	850 - 950
	950 - 1100

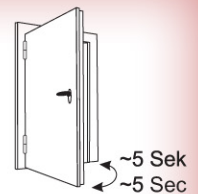

Light-running door must be closed completely by the closer!

GEZE INSTALLATION OPTIONS

General product information about GEZE overhead door closers

Door closer sizes

acc. to EN 1154	Door leaf width in mm
Size 1	up to 750
Size 2	from 750 to 850
Size 3	from 850 to 950
Size 4	from 950 to 1100
Size 5	from 1100 to 1250
Size 6	from 1250 to 1400
Size 7	from 1400 to 1600

Notes for door closers with guide rail for installation on the opposite hinge side

Note: The max. door opening angle must be limited by a door stopper or by use of the GEZE T-Stop guide rail!

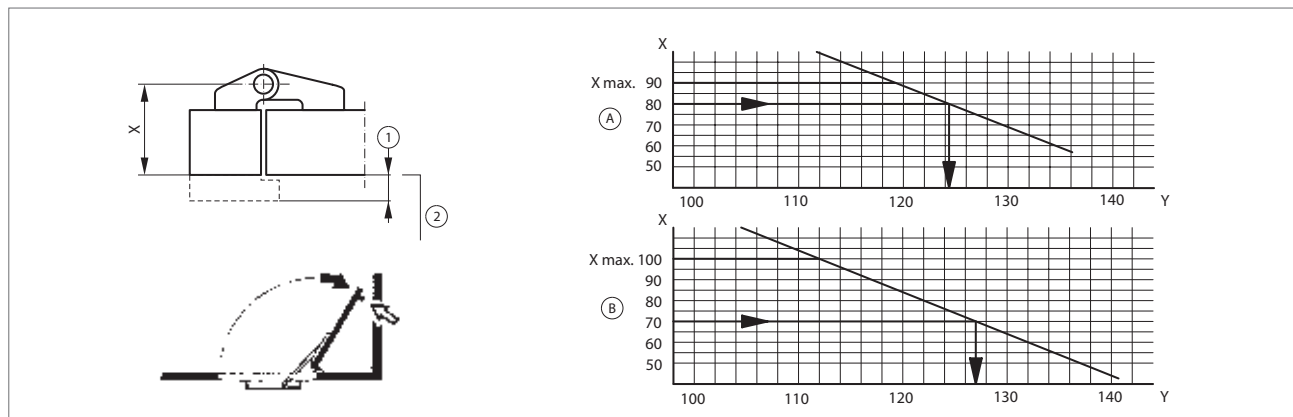

Special mounting dimensions are used when the X dimension is wider – on request.

Notes for door closers with link arm for installation on the opposite hinge side

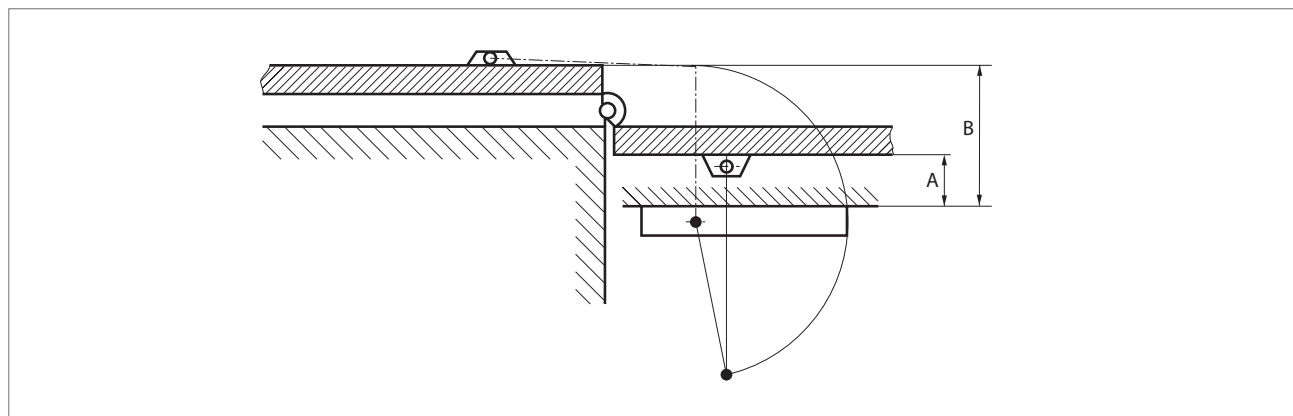

- A = Reveal depth
B = Reveal depth + 2 door size + 2 pivot point distance

Door opening up to 180° is only possible if the following dimensions are not exceeded:
A = 70 mm and B = 200 mm

GEZE INSTALLATION OPTIONS

GEZE TS 1500

Door leaf installation hinge side

TS 1500 Door leaf installation/hinge side

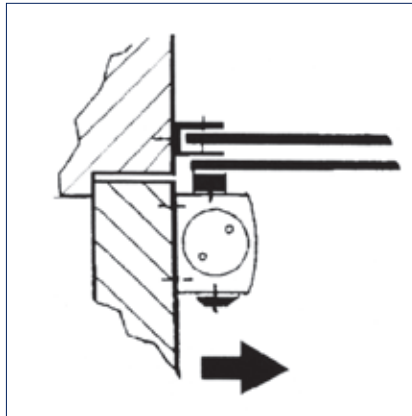
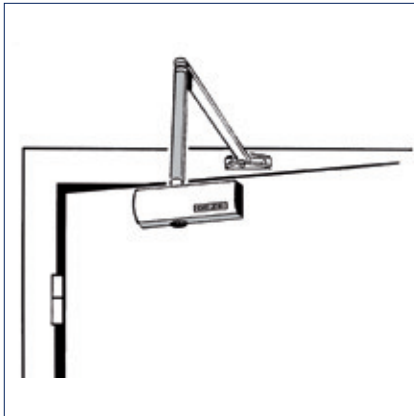

Area of application

- Closing force 3/4 according to EN 1154, leaf width up to 1100 mm
- Can be used for right and left hung doors without conversion

Order information

Description	Version	ID.No.
GEZE TS 1500 Closer Size EN 3/4 (without link arms)	silver	101792
Link arms TS 1500/1000C Standard	silver	101878
Link arms TS 1500/1000C with mechanical hold-open device	silver	101815
Accessories		
Mounting plate door closer for TS 1500	silver	029682

Note: See our system catalogues for further accessories and colour variants.

GEZE INSTALLATION OPTIONS

GEZE TS 1500

Transom installation opposite hinge side

TS 1500 Transom installation/opposite hinge side

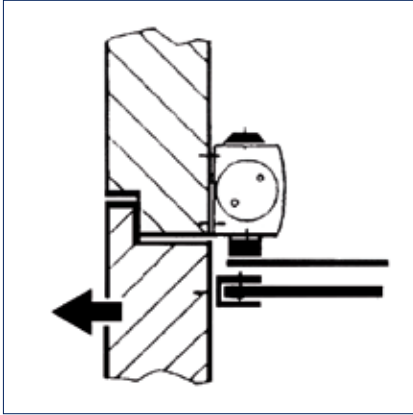

Area of application

- Closing force 3/4 according to EN 1154, leaf width up to 1100 mm
- Can be used for right and left hung doors without conversion

Order information

Description	Version	ID.No.
GEZE TS 1500 Closer Size EN 3/4 (without link arms)	silver	101792
Link arms TS 1500/1000C Standard	silver	101878
Link arms TS 1500/1000C with mechanical hold-open device	silver	101815
Accessories		
Mounting plate door closer for TS 1500	silver	029682

Note: See our system catalogues for further accessories and colour variants.